

DID YOU KNOW?

about our... **XBolt® Torx Drive Button Head**



XBolt

**NEW
PRODUCT**

XBolt® TORX DRIVE BUTTON HEAD MECHANICAL GALVANISED / HEC CARBON STEEL



Part	QFind	Size	Drill Ø Size (mm)	Internal Torx (mm)	Length (mm)	Pack Qty
MXDMSGM060065	MXD100	M6	6	T30	65	50
MXDMSGM060075	MXD101	M6	6	T30	75	50
MXDMSGM060100	MXD102	M6	6	T30	100	50
MXDMSGM080060	MXD103	M8	8	T40	60	50
MXDMSGM080075	MXD104	M8	8	T40	75	50
MXDMSGM080100	MXD105	M8	8	T40	100	50
MXDMSGM100075	MXD106	M10	10	T50	75	50
MXDMSGM100100	MXD107	M10	10	T50	100	50
MXDMSGM100150	MXD108	M10	10	T50	150	50

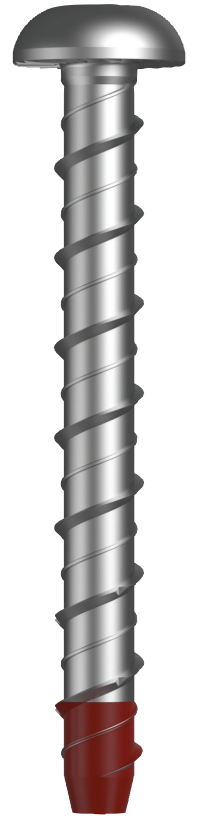

Another quality Hobson XBolt® screw anchor product with a Torx Drive Button Head. Hobson has given project designers another choice of head style and shape in their application.

Application:

Temporary or permanent formwork, street furniture, park benches and in prisons as an anti-tamper anchor. XBolts® can be used closer to the edge of the base material (concrete) than other mechanical anchors as the XBolt® has no expansion forces.

The Torx drive is used as an anti-tamper anchor because prisoners have less access to Torx drive bits, but the anchor and the base material can still be moved when needed.

Installation:

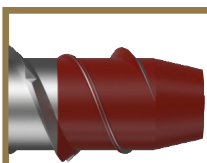
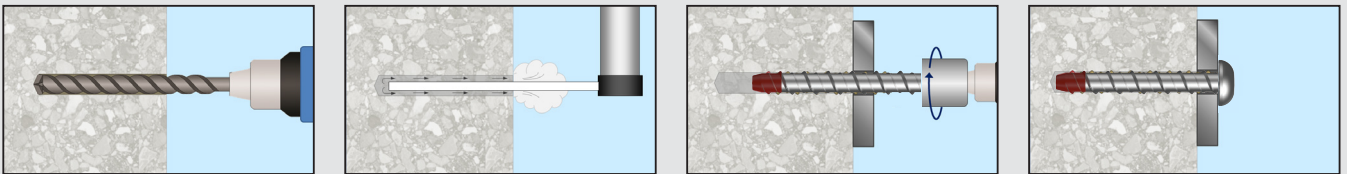

XBolts® are single unit screw type anchors that are used in solid concrete applications. Fixing is achieved by screwing the anchor into a drilled hole in concrete. As it is screwed in, the anchor taps the hole, thus enabling it to produce a mechanical interlock with the concrete.

CONSTRUCT

1804211DYK

