

DID YOU KNOW?

about our...



**NEW
PRODUCT**

Lifting Dee Shackle Screw Pin

The lifting dee shackle screw pin is effective for lifting, tensioning and staying systems, and is manufactured according to AS 2741.

LIFTING DEE SHACKLE SCREW PIN POWDER COAT / HEC2741 / GRADE S

Part	Qfind	WLL (tonne)	Dimensions (mm)				
			D	W	L	E	d
ULSHGSGDD-06	DDS6	0.50	8	12	22	17	6
ULSHGSGDD-08	DDS8	0.75	10	13	26	21	8
ULSHGSGDD-10	DDS10	1.00	11	17	32	25	10
ULSHGSGDD-11	DDS11	1.50	13	18	37	27	11
ULSHGSGDD-13	DDS13	2.00	16	21	41	33	13
ULSHGSGDD-16	DDS16	3.20	22	27	51	40	16
ULSHGSGDD-19	DDS19	4.70	22	32	60	48	19
ULSHGSGDD-22	DDS22	6.50	25	37	71	54	22
ULSHGSGDD-25	DDS25	8.50	29	43	81	60	25
ULSHGSGDD-29	DDS29	9.50	32	46	90	67	29
ULSHGSGDD-32	DDS32	11.00	35	52	100	76	32
ULSHGSGDD-35	DDS35	13.50	38	57	113	84	35
ULSHGSGDD-38	DDS38	17.00	41	60	124	92	38

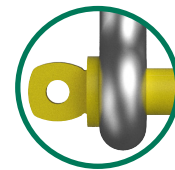

Galvanised finish with
yellow painted pin

APPLICATIONS

- Links in lifting systems
- Rigging connections
- Tension structures
- Multi-sling connections
- Vehicle recovery and towing



FEATURES

- Approved for lifting
- Screw pin
- Complies with AS 2741

MARKINGS:

- **CE** (European Conformity)
- **WLL** (Working Load Limit)
- **Trace Code**
(linked to certificate online)
- **Grade**
- **Manufacturer's mark**

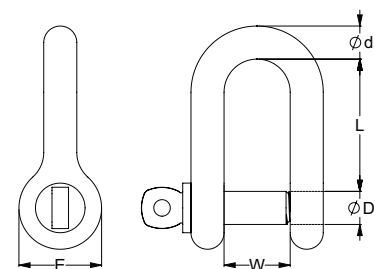

You can download this
Test Certificate and/or
Report from our website:
hobson.com.au

Disclaimer: while every reasonable effort has been made to ensure that this document is correct at the time of printing, Hobson Engineering®, its agencies and employees disclaim all liability in respect to anything or the consequences of anything done or omitted regarding the whole or any part of this document.

Bolt Tension | Anti-Vibration | Product Reliability | Traceability

hobson.com.au QUALITY FASTENERS SINCE 1935

