

DID YOU KNOW?

about our...



**NEW
PRODUCT**

Lifting Eye Nut DIN 582

LIFTING EYE NUT HOT DIP GALVANISED / DIN 582 / GRADE C15E

Part	QFind	Size	Dimensions (mm)				
		M	H	E	ØD	ØID	ØOD
ULENC5GD5M10	ENCGM10	M10	45	10	25	25	45
ULENC5GD5M12	ENCGM12	M12	53	11	30	30	54
ULENC5GD5M16	ENCGM16	M16	62	13	35	35	63
ULENC5GD5M20	ENCGM20	M20	71	16	40	40	72

FEATURES

- Approved and certified for lifting
- Can be used in axial or angular loading

APPLICATIONS

- Connection point for anchoring, rigging, pulling, lifting or hoisting.
- Can be used with ropes, cables, shackles and hooks.
- Threaded onto steel equipment, machine and structures.
- Bolt through steel or timber profiles.

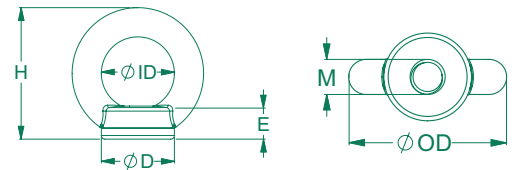

MARKINGS:



- **Material Grade** (C15E)
- **CE** (European Conformity)
- **Axial direction**
- **WLL** (Working Load Limit)
- **Size**
- **Manufacturer's mark**



You can download this
Test Certificate and/or
Report from our website:

hobson.com.au

Disclaimer: While every reasonable effort has been made to ensure that this document is correct at the time of printing, Hobson Engineering®, its agencies and employees, disclaim any and all liability to any person in respect of anything or the consequences of anything done or omitted to be done in reliance upon the whole or any part of this document.

Bolt Tension | Anti-Vibration | Product Reliability | Traceability

hobson.com.au **QUALITY FASTENERS SINCE 1935**



230725DYK