

DID YOU KNOW?

about our...

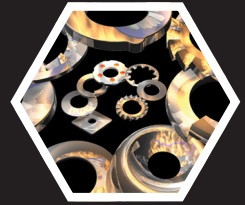

**NEW
PRODUCT**

Disc Spring Washer 4L

Trep® spring washers are anti-loosening security systems/washers.

Trep® 4L spring washers consist of four interdependent smooth tapered spring washers assembled with a metal insert.

TREP® 4L SPRING WASHER PLAIN / TREP

Part	D	d	e	h
	(mm)	(mm)	(mm)	(mm)
WGHTPT4LM06	17	6.5	2.4	0.80
WGHTPT4LM08	20	8.5	2.8	0.95
WGHTPT4LM10	23	10.5	3.2	1.05
WGHTPT4LM12	26	12.5	4.0	1.30
WGHTPT4LM14	29	15.0	4.8	1.30
WGHTPT4LM16	33	17.0	4.8	1.40
WGHTPT4LM18	37	19.0	6.0	1.52
WGHTPT4LM20	41	21.0	6.0	1.85
WGHTPT4LM22	45	23.0	7.2	1.67
WGHTPT4LM24	50	25.0	7.2	1.84
WGHTPT4LM27	56	28.5	8.0	1.80
WGHTPT4LM30	60	32.0	8.8	2.30
WGHTPT4LM33	64	35.0	10.0	2.57
WGHTPT4LM36	68	38.0	10.0	2.50
WGHTPT4LM39	72	41.0	10.0	2.45

FEATURES

- Guaranteed resistance to loosening
- Sustained tensioning of assembled elements
- Even distribution of bearing pressure
- High-stiffness, low-deformability elastic system
- Can accommodate thermal expansion
- Capacity to compensate and/or take up play (expansion, wear, etc)
- Safe, easy assembly through crimping (only one part needs handling instead of three or four)
- No marring of clamped components

Disclaimer: while every reasonable effort has been made to ensure that this document is correct at the time of printing, Hobson Engineering®, its agencies and employees disclaim all liability in respect to anything or the consequences of anything done or omitted regarding the whole or any part of this document.

TREP®

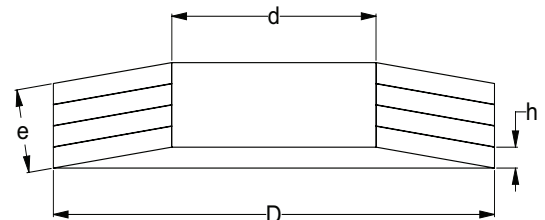
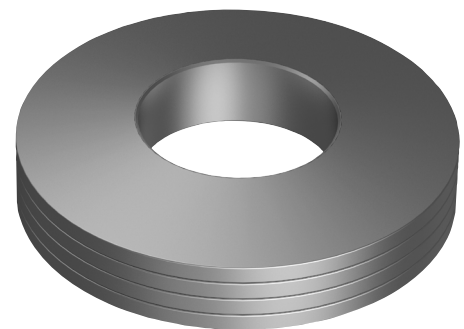

TREP® spring washers are made from carbon steel C > 0.75%.

Their characteristics are obtained after core hardening.

TREP® 4L spring washer is compatible with bolt property classes 5.6 to 8.8.



You can download this
Test Certificate and/or
Report from our website:

hobson.com.au

Bolt Tension | Anti-Vibration | Product Reliability | Traceability

hobson.com.au QUALITY FASTENERS SINCE 1935

