

DID YOU KNOW?

about our...



**NEW
PRODUCT**

R Clip Humpback Pin

R CLIP HUMPBAC PIN ZINC PLATED / HEC / MILD STEEL

Part	Size	A	B		D	L
			min	max		
	(mm)	(mm)	(mm)	(mm)	(mm)	(mm)
QPRMSZM012	1.2	3.0	1.7	2.3	1.18	14
QPRMSZM016	1.6	4.8	2.1	2.7	1.58	27
QPRMSZM020	2.0	9.5	3.5	4.1	1.98	54
QPRMSZM024	2.4	12.0	3.7	4.3	2.38	56
QPRMSZM032	3.2	17.5	4.2	4.8	3.18	63
QPRMSZM035	3.5	17.5	5.7	6.3	3.48	71
QPRMSZM038	3.8	19.5	5.7	6.3	3.78	75
QPRMSZM045	4.5	22.5	6.7	7.3	4.48	96
QPRMSZM050	5.0	23.0	7.2	7.8	4.98	96
QPRMSZM062	6.2	29.0	11.7	12.3	6.18	118
QPRMSZM070	7.0	29.0	11.7	12.3	6.98	118
QPRMSZM079	7.9	29.0	12.7	13.3	7.88	122

FEATURES

- R shaped

APPLICATIONS

- Used to secure the ends of round shapes such as axles and clevis pins

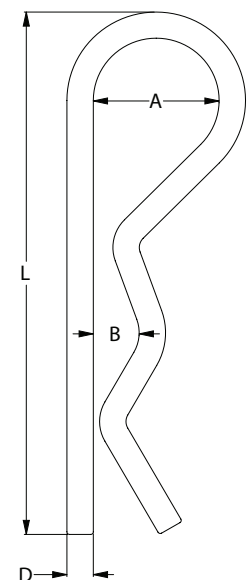
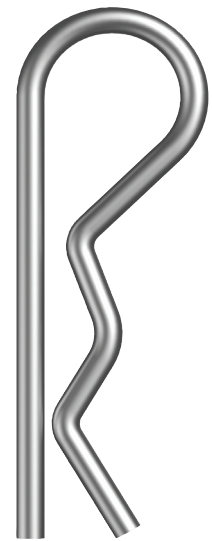

Disclaimer: while every reasonable effort has been made to ensure that this document is correct at the time of printing, Hobson Engineering®, its agencies and employees disclaim all liability in respect to anything or the consequences of anything done or omitted regarding the whole or any part of this document.

Bolt Tension | Anti-Vibration | Product Reliability | Traceability

hobson.com.au **QUALITY FASTENERS SINCE 1935**



231102DYK