

DID YOU KNOW?

about our...



**NEW
PRODUCT**

Strut Channel Nut Long Spring

STRUT CHANNEL NUT LONG SPRING ZINC PLATED (ROHS COMPLIANT) / HEC

Part	Diameter	A	B	C	L	d2
		(mm)	(mm)	(mm)	(mm)	(mm)
NSMSZSLCM06	M6	19	34.5	6.0	38	18
NSMSZSLCM08	M8	19	34.5	8.0	38	18
NSMSZSLCM10	M10	19	34.5	9.2	38	18
NSMSZSLCM12	M12	19	34.5	12.0	38	18
NSMSZSLCM16	M16	29	34.5	11.0	38	18



FEATURES

- Easy install and precise placement
- Spring holds the nut securely in place, acting as a 'third hand'
- Freedom to adjust positioning
- Serrated grooves on the top face prevent unwanted movement or rotation

APPLICATIONS

- Securing cable trays and ladders onto channel (strut)
- Using an angle fitting to make a right-angle connection between two lengths of channel
- Fixing of channel supports to strut
- Deep channel sections (41x41mm channel)

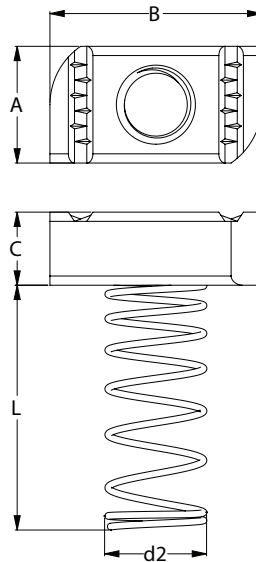

Disclaimer: while every reasonable effort has been made to ensure that this document is correct at the time of printing, Hobson Engineering®, its agencies and employees disclaim all liability in respect to anything or the consequences of anything done or omitted regarding the whole or any part of this document.

Bolt Tension | Anti-Vibration | Product Reliability | Traceability

hobson.com.au **QUALITY FASTENERS SINCE 1935**



2312141DYK