

# DID YOU KNOW?

about our...



**NEW  
PRODUCT**

## Rivet Dome Triform

### RIVET DOME TRIFORM PLAIN / 5154 ALUMINIUM / ALUMINIUM

Part	Diameter D (mm)	Grip Range G (mm)		Body Length L (mm)	Head Diameter H (mm)
		Min	Max		
R9P73FAA504	4.0	3.2	6.4	18	8.0
R9P73FAA506	4.0	3.2	9.5	21	8.0
R9P73FAA508	4.0	6.4	12.7	25	8.0
R9P73FAA604	4.8	3.2	6.4	18	9.6
R9P73FAA606	4.8	3.2	9.5	20	9.6
R9P73FAA608	4.8	6.4	12.7	24	9.6

#### APPLICATIONS

- Wood, plastics, plasterboard and insulation materials
- Situations requiring high shear load and pull-out capacities

#### FEATURES

- Triformed body ensures less material damage
- Triform rivets separate into three parts upon installation, leaving a large surface area on the blind side of the rivet to prevent damage to the material

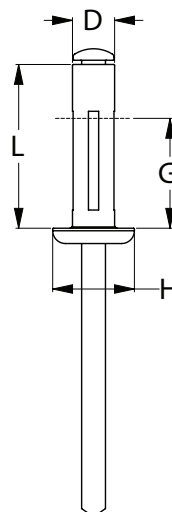

# DRILLX<sup>®</sup>



You can download this  
Test Certificate and/or  
Report from our website:  
**[hobson.com.au](http://hobson.com.au)**

Disclaimer: while every reasonable effort has been made to ensure that this document is correct at the time of printing, Hobson Engineering®, its agencies and employees disclaim all liability in respect to anything or the consequences of anything done or omitted regarding the whole or any part of this document.

Bolt Tension | Anti-Vibration | Product Reliability | Traceability

**[hobson.com.au](http://hobson.com.au) QUALITY FASTENERS SINCE 1935**



240102DYK