

DID YOU KNOW?

about our...



**NEW
PRODUCT**

Barrel Nut Countersunk Post Torx®

BARREL NUT COUNTERSUNK POST TORX®

316 STAINLESS / HEC SECURITY / A4



316



Part	Nominal Size	Length	Thread Length	Body Diameter	Head Height	Head Diameter
	D (mm)	L (mm)	TL (mm)	S (mm)	C (mm)	H (mm)

INB16CTM040012	4	12	6.5	5.4	2.3	8
INB16CTM050015	5	15	8.0	6.4	2.8	10
INB16CTM060020	6	20	10.0	7.9	3.3	12
INB16CTM080020	8	20	12.0	9.9	4.4	16
INB16CTM100028	10	28	20.3	11.9	5.2	20

FEATURES

- Two-way security fitting
- Used with Hobson IMS04CTM parts to create an even appearance on both sides
- Post torx drive for anti-tamper attribute
- Grade 316 material for harsh outdoor and marine environments

APPLICATIONS

- Used for furniture connections
- Used in children's playgrounds and other areas where security is important
- Symmetrical finish where safety and appearance are vital. Conceals possible protruding thread and ensures no exposed threads

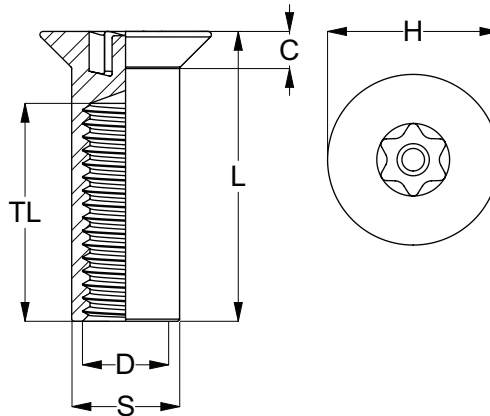

You can download this Test Certificate and/or Report from our website:

hobson.com.au

Disclaimer: while every reasonable effort has been made to ensure that this document is correct at the time of printing, Hobson Engineering®, its agencies and employees disclaim all liability in respect to anything or the consequences of anything done or omitted regarding the whole or any part of this document. HEC product marking is the manufacturing mark of Hobson Engineering. HEC is a registered trademark of Hobson Engineering.

Bolt Tension | Anti-Vibration | Product Reliability | Traceability

hobson.com.au **QUALITY FASTENERS SINCE 1935**



240320DYK