

DID YOU KNOW?

about our...



**MORE
SIZES +**

Connector Bond Beam

CONNECTOR BOND BEAM HOT DIP GALVANISED / HEC / 2x HOLE

Part	Width	Length	Diameter 1	Diameter 2	Thickness	Pitch
	A (mm)	L (mm)	D1 (mm)	D2 (mm)	t (mm)	P (mm)
GTBGB14014135	75	135	14	14	10	85
GTBGB14017200	50	200	14	17	6	150
GTBGB14017250	50	250	14	17	6	200
GTBGB14019200	50	200	14	19	6	150
GTBGB17017200	50	200	17	17	6	150
GTBGB17017250	50	250	17	17	6	200
GTBGB17019200	50	200	17	19	6	150
GTBGB17019225	50	225	17	19	6	175
GTBGB17019250	50	250	17	19	6	200
GTBGB18018170	75	170	18	18	12	120



**NEW
SIZES +**

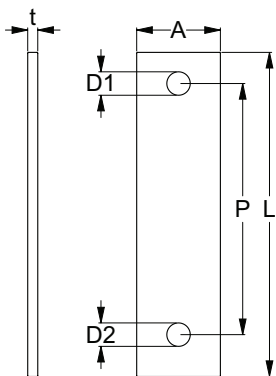

APPLICATIONS

- Used as a tie down system to secure roofs on block style homes in cyclonic conditions
- Rebar is fed through the bottom hole inside the concrete block before concrete is poured over it. The trusses then bolt through the top hole

FEATURES

- D1 hole bolts the truss while D2 hole is used for the rebar
- D2 hole is larger to fit threaded rebar
- Hobson's range is available in different hole sizes to suit various applications and bolt sizes

Disclaimer: while every reasonable effort has been made to ensure that this document is correct at the time of printing, Hobson Engineering®, its agencies and employees disclaim all liability in respect to anything or the consequences of anything done or omitted regarding the whole or any part of this document. HEC product marking is the manufacturing mark of Hobson Engineering. HEC is a registered trademark of Hobson Engineering.

Bolt Tension | Anti-Vibration | Product Reliability | Traceability

hobson.com.au **QUALITY FASTENERS SINCE 1935**

