

# DID YOU KNOW?

about our...



**NEW  
PRODUCT**

## Tilt Panel Brace Shear Pin

**TILT PANEL BRACE SHEAR PIN**  
ZINC YELLOW PASSIVATE / HEC RATED 200HV / AS 3850

Part	QFind	Diameter	From End to Bend	Full Length	Width
		D (mm)	L1 (mm)	L2 (mm)	W (mm)
QPPCSYSP-16	QPP1	16	124	165	40

### APPLICATIONS

- Used in tilt panel props to adjust height

### FEATURES

- Increased hardness creates higher shear failure point for enhanced safety

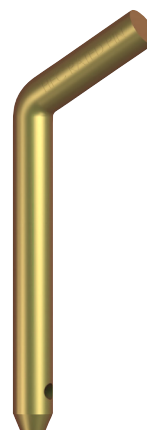
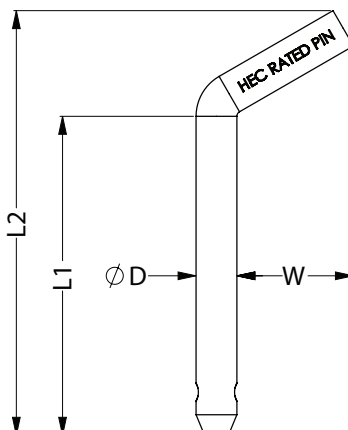

You can download this  
Test Certificate and/or  
Report from our website:  
[hobson.com.au](http://hobson.com.au)

Disclaimer: while every reasonable effort has been made to ensure that this document is correct at the time of printing, Hobson Engineering®, its agencies and employees disclaim all liability in respect to anything or the consequences of anything done or omitted regarding the whole or any part of this document. HEC product marking is the manufacturing mark of Hobson Engineering. HEC is a registered trademark of Hobson Engineering.

Bolt Tension | Anti-Vibration | Product Reliability | Traceability

[hobson.com.au](http://hobson.com.au) **QUALITY FASTENERS SINCE 1935**



250415DYK