

DID YOU KNOW?

about our...



**SPOT
LIGHT**

Weathering Steel Range

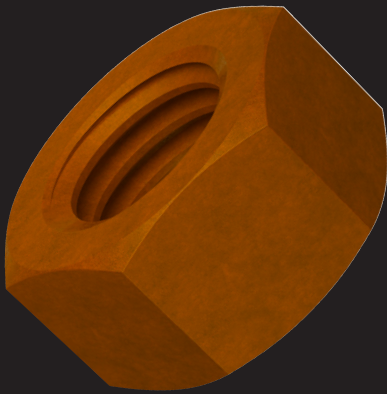

NH83WCM

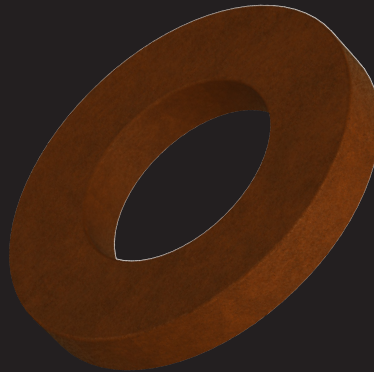

WR43WM

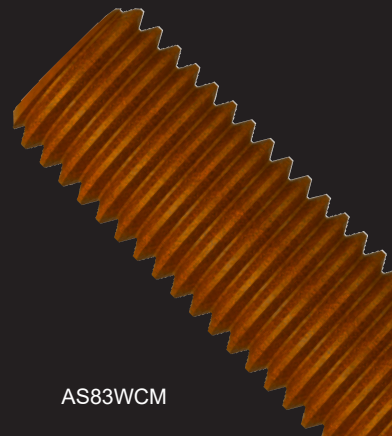

AS83WCM

Patina Colour Over Time

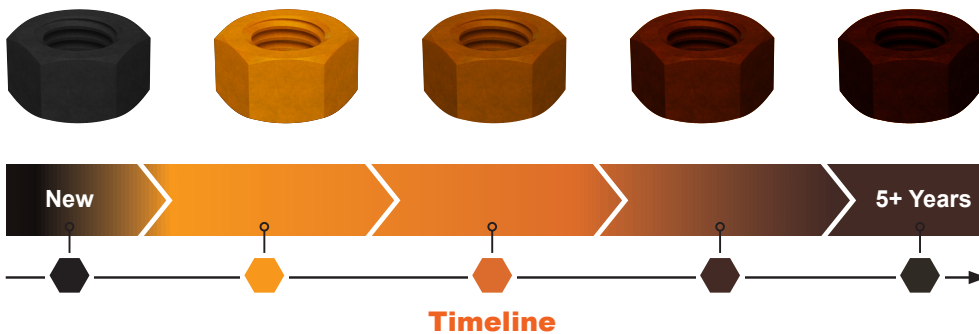

Suitable for use with Redcor® composition A and B

Disclaimer: while every reasonable effort has been made to ensure that this document is correct at the time of printing, Hobson Engineering®, its agencies and employees disclaim all liability in respect to anything or the consequences of anything done or omitted regarding the whole or any part of this document. HEC product marking is the manufacturing mark of Hobson Engineering. HEC is a registered trademark of Hobson Engineering.

Bolt Tension | Anti-Vibration | Product Reliability | Traceability

hobson.com.au **QUALITY FASTENERS** SINCE 1935



DID YOU KNOW?

about our...



**SPOT
LIGHT**

Weathering Steel Range

SAMPSONROD® WEATHERING STEEL / DIN 976 / CLASS 8.8

Part	Diameter	Length
	(mm)	(m)
AS83WCM241000	M24	1
AS83WCM301000	M30	1
AS83WCM361000	M36	1

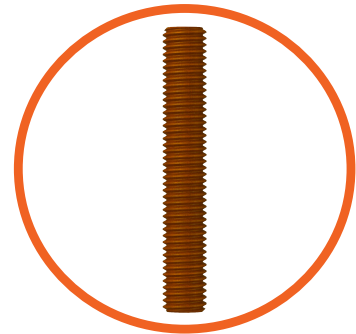

STRUCTURAL NUT WEATHERING STEEL / ASTM A563M / CLASS 8

Part	Nominal Size	Height	Across Flats
	(mm)	(mm)	(mm)
NH83WCM24	M24	24.2	41
NH83WCM30	M30	30.7	50
NH83WCM36	M36	36.6	60

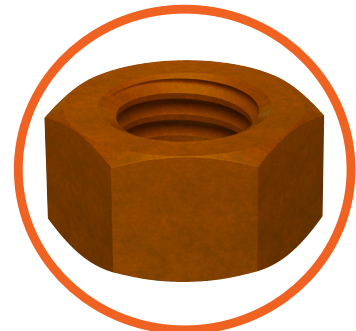

FLAT ROUND SAMPSON® WASHER WEATHERING STEEL / ASTM F436M / 38–45 HRC

Part	Diameter
	(mm)
WR43WM24	M24
WR43WM30	M30
WR43WM36	M36



► Used in **Weathering Steel** applications

Disclaimer: while every reasonable effort has been made to ensure that this document is correct at the time of printing, Hobson Engineering®, its agencies and employees disclaim all liability in respect to anything or the consequences of anything done or omitted regarding the whole or any part of this document. HEC product marking is the manufacturing mark of Hobson Engineering. HEC is a registered trademark of Hobson Engineering.

Bolt Tension | Anti-Vibration | Product Reliability | Traceability

hobson.com.au **QUALITY FASTENERS SINCE 1935**



2506042DYK