

DID YOU KNOW?

about our...



**NEW
PRODUCT**

Reduced Base Arc Stud

REDUCED BASE ARC STUD PLAIN / AS 1554.2 / CLASS 4.8

| Part | QFind | Diameter | | Thread Length | Point Length | Length | |
|----------------|----------------|----------|---------|---------------|--------------|-------------|------------|
| | | d1 (mm) | d2 (mm) | | | Before Weld | After Weld |
| MSSMSRDM160040 | SRD1640 | 16 | 13.2 | 33 | 10 | 43 | 40 |

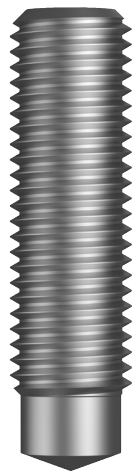

APPLICATIONS

- Wear plates
- Applications requiring limited space around the stud
- Electronic and automotive assemblies
- Construction

FEATURES

- A reduced base means the shank diameter is less than the major diameter of the thread. It is used to decrease the clearance hole size
- Length before weld is approx. 3–4 mm longer
- Includes flux ball at the end of the stud to help stabilise the electric arc, resulting in a stronger and cleaner weld

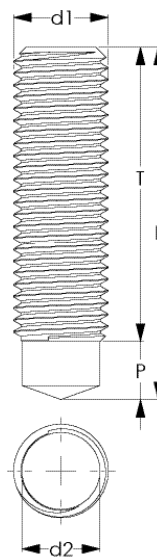

You can download this Test Certificate and/or Report from our website:

hobson.com.au

Disclaimer: while every reasonable effort has been made to ensure that this document is correct at the time of printing, Hobson Engineering®, its agencies and employees disclaim all liability in respect to anything or the consequences of anything done or omitted regarding the whole or any part of this document. HEC product marking is the manufacturing mark of Hobson Engineering. HEC is a registered trademark of Hobson Engineering.

Bolt Tension | Anti-Vibration | Product Reliability | Traceability

hobson.com.au QUALITY FASTENERS SINCE 1935

