



# PRODUCT DATA

## Spaghetti Roll Continuous Plugs

The Spaghetti roll plugs are suitable for light duty anchoring in concrete, solid brick, solid block and stone.

Simply pre-drill the base material, push the spaghetti in and cut-off at the required length. Complete the installation with a screw or nail through the fixture and into the spaghetti-plug.

## CONSTRUCT



For use with minimum 3.5mm nails or 6 or 8 gauge screws



The roll enables you to cut the plugs at the desired length to suit the fixing application.

Applications	Trades
<ul style="list-style-type: none"> <li>Lighting</li> <li>Electrical switches and power points</li> <li>Brackets</li> <li>Shelves</li> <li>Letterboxes</li> <li>Signage</li> </ul>	<ul style="list-style-type: none"> <li>Plumbers</li> <li>Electricians</li> <li>Builders</li> <li>Sign Installer</li> </ul>

<b>Material</b>	Plastic
-----------------	---------

<b>Finish</b>	Plastic
---------------	---------

Part	QFind	Drill Dia Ø	Length	Screw Gauge	Nail Size	Plastic Thickness	Colour	Pack Qty	
		(mm)	(m)		(mm)	µm			
MWPSR50050	SR5050	5.0	50	6	3.5	100	Green	1	
MWPSR55050	SR5550	5.5	50	6 or 8	3.5 - 4.0	100	Red	1	
MWPSR55005	SR5505	5.5	5	6 or 8	3.5 - 4.0	100	Red	1	

### Installation

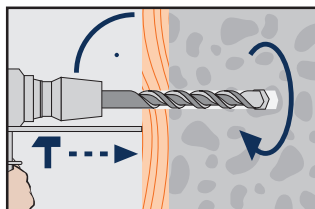

1. Drill a 5.0-5.5mm diameter hole. Drill hole to required depth so that screw or nail can be driven home.

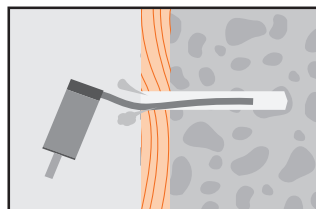

2. Clean hole thoroughly of dust and debris.

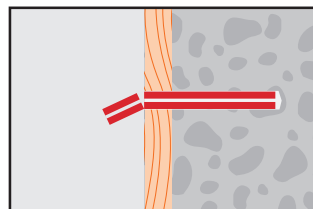

3. Insert spaghetti wire to full depth of hole and cut off.

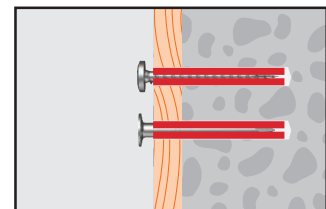

4. With fixture firmly held in place fasten with a 6 or 8 gauge screw or minimum 3.5mm nail.

Disclaimer: While every reasonable effort has been made to ensure that this document is correct at the time of printing, Hobson Engineering®, its agencies and employees, disclaim any and all liability to any person in respect of anything or the consequences of anything done or omitted to be done in reliance upon the whole or any part of this document.

Bolt Tension | Anti-Vibration | Product Reliability | Traceability

[hobson.com.au](http://hobson.com.au) **QUALITY FASTENERS SINCE 1935**