



PRODUCT DATA

Nylon Render Washer

| Applications | Trades |
|---|---|
| <ul style="list-style-type: none"> Fixing of thermal insulated wall panels | <ul style="list-style-type: none"> Builders Renderers |

| | |
|----------|--------------------|
| Material | Nylon Polyethylene |
|----------|--------------------|

| | |
|--------|--------------------|
| Finish | Nylon Polyethylene |
|--------|--------------------|

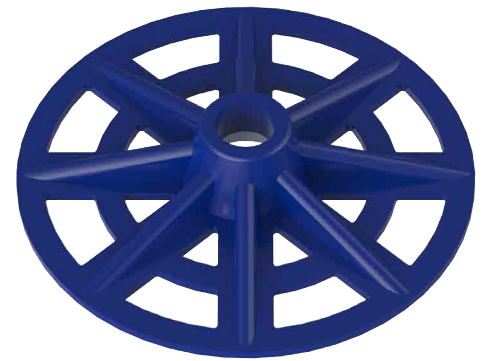

| Part | QFind | Screw Gauge | OD | ID | Tapered Thickness | Colour | Pack Weight | Pack Qty |
|--------------|-------|-------------|----------|----------|-------------------|--------|-------------|----------|
| | | to suit | min (mm) | min (mm) | T min (mm) | | (kg) | |
| WRPEBRM05040 | WR40 | #10/M5 | 42 | 5.2 | 7.6 | Blue | 0.156 | 100 |

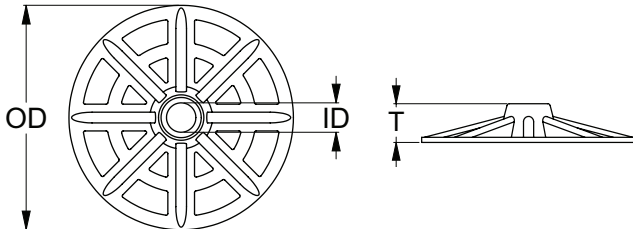

Features

- Lightweight and easy to install
- Raised face and 8 reinforcing ribs to prevent spinning during installation
- Large outside diameter for contact with panels

Installation

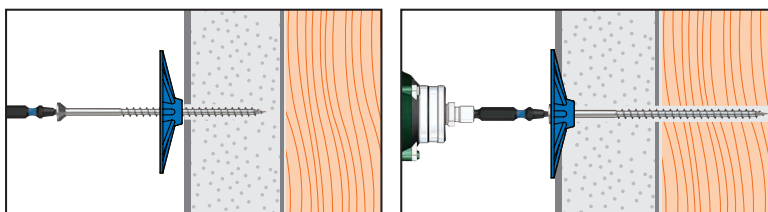

Installation Guides

Position washer and install fasteners evenly across wall. To avoid distortion of the product or substrate around the washer, do not over tighten.

Washers are used with 10 gauge countersunk screws of various lengths.

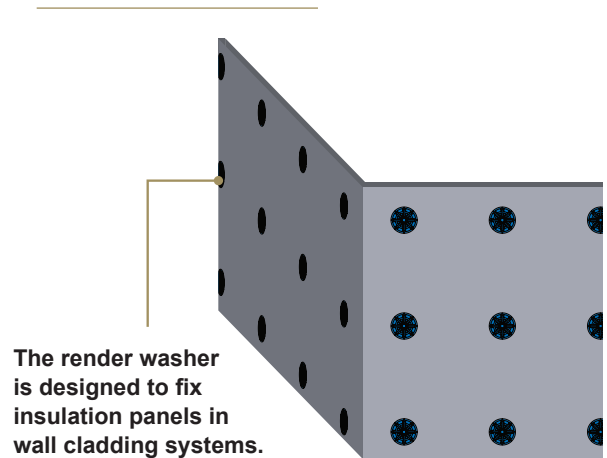

The render washer is designed to fix insulation panels in wall cladding systems.

Disclaimer: While every reasonable effort has been made to ensure that this document is correct at the time of printing, Hobson Engineering®, its agencies and employees, disclaim any and all liability to any person in respect of anything or the consequences of anything done or omitted to be done in reliance upon the whole or any part of this document.