



# PRODUCT DATA



## XBolt® Bite™ Anchor (Internal Thread)

Page 1 of 2

Internally threaded self-tapping anchor for suspension applications and fixings into concrete. The bite is an alternate to the drop-in anchor and offers the advantage of a non-expansion fixing.

# XBolt BITE®

Applications	Trades	Base Materials
<ul style="list-style-type: none"> <li>Suspension of mechanical services</li> <li>Pipe supports</li> <li>Cable trays</li> <li>Fire sprinklers</li> <li>Suspended lighting</li> <li>Alternative to drop-in anchor</li> </ul>	<ul style="list-style-type: none"> <li>Plumbers</li> <li>Electricians</li> <li>Mechanical service installers</li> <li>Air conditioning</li> </ul>	<ul style="list-style-type: none"> <li>Concrete</li> </ul>

<b>Material</b>	 Carbon Steel
<b>Finish</b>	 R1000 Protective Coat

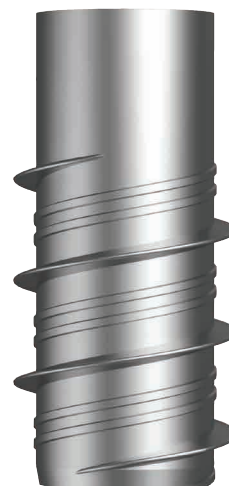

### Features

- Internal (female) thread allows easy adjustment of bolt or rod.
- Bolt or rod can easily be removed.
- Fast installation with cordless tool (hammer setting should not be used).

Part	QFind	Internal Thread Diameter	Internal Hex Drive	Length	Internal Thread Length	Drill Hole ø	Major Diameter	Pack Qty
			AF (mm)	L (mm)	(mm)	(mm)	A (mm)	
MXBMSRM100037	<b>MXB101</b>	M10	10	37	20	15	17	100
MXBMSRM120042	<b>MXB102</b>	M12	12	42	25	18	20	50

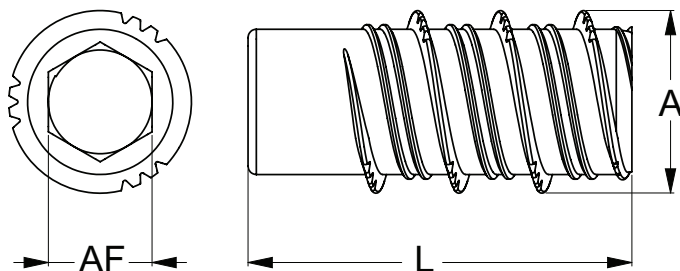

## Self-tapping Suspension Anchor

Disclaimer: While every reasonable effort has been made to ensure that this document is correct at the time of printing, Hobson Engineering®, its agencies and employees, disclaim any and all liability to any person in respect of anything or the consequences of anything done or omitted to be done in reliance upon the whole or any part of this document.

Bolt Tension | Anti-Vibration | Product Reliability | Traceability

**hobson.com.au** **QUALITY FASTENERS SINCE 1935**



# PRODUCT DATA

## XBolt® Bite™ Anchor (Internal Thread)

Page 2 of 2

Part	Concrete Strength	Drill Hole Ø	Min Drill Depth	Min Embed. Depth	Min Anchor Spacing	Min Edge Distance	Working Load in Tension <sup>1</sup>
	(MPa)	(mm)	(mm)	(mm)	(mm)	(mm)	(kN)
MXBMSRM100037	32	15	42	37	111	56	3
MXBMSRM120042	32	18	47	42	126	63	4

<sup>1</sup> Working load is the governing minimum allowable load obtained by comparing relevant concrete and steel working loads. Factor of Safety (FOS=2.5 for steel and FOS=3.0 for concrete) are already included.

### Installation

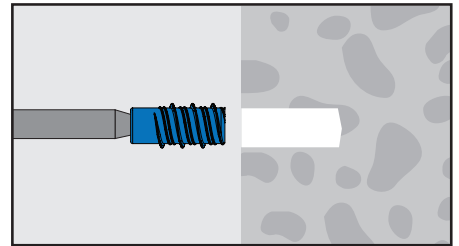
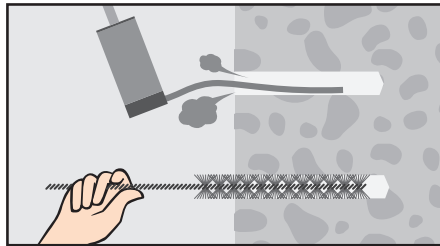
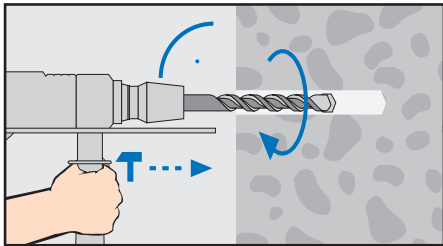

### Standard Fixing

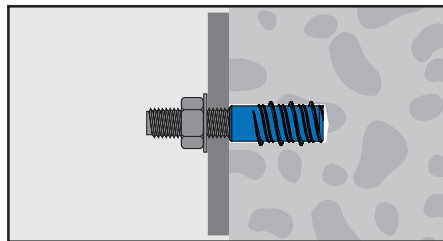

### Suspension Fixing

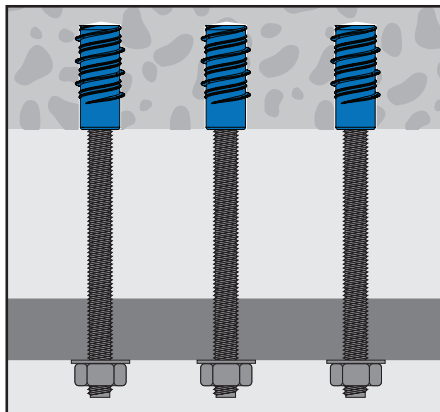

Disclaimer: While every reasonable effort has been made to ensure that this document is correct at the time of printing, Hobson Engineering®, its agencies and employees, disclaim any and all liability to any person in respect of anything or the consequences of anything done or omitted to be done in reliance upon the whole or any part of this document.

Bolt Tension | Anti-Vibration | Product Reliability | Traceability

**hobson.com.au** **QUALITY FASTENERS SINCE 1935**