

PRODUCT DATA

BDX Metal SDS Flanged Hex Head

Applications	
<ul style="list-style-type: none"> • Metal to metal fixing • Wall cladding • Sheds • Fencing and gates • Signage • Hinges into metal posts, gates, and doors • Stitching for flashing 	

Material	 C1022 Hardened
-----------------	---

Finish	 X9 Coating
---------------	--



14 Gauge Hex Head

X9 ProteXion coating is suitable for ISO 9223 Category 4 environments.

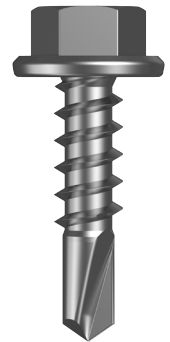

Dimensions

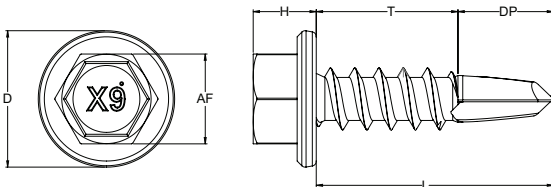

Part	QFind	Gauge	TPI	Length	Thread Length	Drill Point Length	Head Height	Head ø	Drive Size
				L (mm)	T (mm)	DP (mm)	H (mm)	D (mm)	AF (inch)
T9PM9FH1410025	QH222	14	10	25	15	10	6.5	15	HEX 3/8

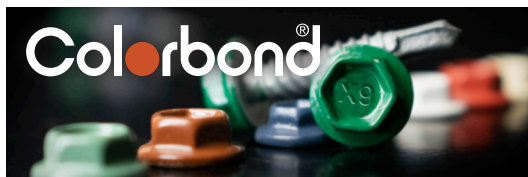

Refer to our documents online for a complete list of available Colorbond® colours.

hobson.com.au

Disclaimer: while every reasonable effort has been made to ensure that this document is correct at the time of printing, Hobson Engineering®, its agencies and employees disclaim all liability in respect to anything or the consequences of anything done or omitted regarding the whole or any part of this document. HEC product marking is the manufacturing mark of Hobson Engineering. HEC is a registered trademark of Hobson Engineering.

Bolt Tension | Anti-Vibration | Product Reliability | Traceability

hobson.com.au **QUALITY FASTENERS SINCE 1935**



PRODUCT DATA

BDX Metal SDS Flanged Hex Head

Pullout Values

Plate (Purlin)	Metal Plate Thickness	¹ Mean Load	² Characteristic Load	³ Working Load
	(mm)		(N)	(N)
G2	0.8	1150	1000	400
G2	1.2	2100	1750	700
G450	1.6	4750	4300	1700
G450	2.0	6300	6000	2400
G450	2.5	8000	7350	2950
G2	3.0	8150	7450	3000

Mechanical Properties

Torsional Strength	¹ Mean Tensile Strength	¹ Mean Shear Strength	² Characteristic Tensile Strength	² Characteristic Shear Strength
(Nm)	(N)	(N)	(N)	(N)
14.1	21200	12700	20850	12500

Drill Point Test

Plate (Purlin)	Metal Plate Thickness	Load	Drill Speed	Drill Time	Drill Time
	(mm)	(kg)	(RPM)	(Max. individual) Seconds	(Max. average) Seconds
G450	2.5	24	2200	4	3

Note: 1000N = 1kN

¹ Mean Load/Strength is the average ultimate strength of samples tested.

² Characteristic Load/Strength: 95% of these screws are expected to have a strength greater than the loads shown.

³ Working Load is the governing minimum allowable load obtained by comparing relevant concrete and steel working loads. Factor of Safety (FOS=2.5 for steel, FOS=2.5 for timber and FOS=3.0 for concrete) are already included.

All values are obtained under laboratory conditions. Safety factors should be considered for design purposes. Actual pullout loads may differ slightly depending on certain properties of the base material.

Disclaimer: while every reasonable effort has been made to ensure that this document is correct at the time of printing, Hobson Engineering®, its agencies and employees disclaim all liability in respect to anything or the consequences of anything done or omitted regarding the whole or any part of this document. HEC product marking is the manufacturing mark of Hobson Engineering. HEC is a registered trademark of Hobson Engineering.

Bolt Tension | Anti-Vibration | Product Reliability | Traceability

hobson.com.au **QUALITY FASTENERS SINCE 1935**

PRODUCT DATA

BDX Metal SDS Flanged Hex Head

Installation

1. Use a cordless screw gun set between 2,200–3,000 RPM. Fit the Hex Drive Bit over the screw and place at the fastening position.
2. Apply consistently firm pressure to the screw driver while the screw is drilling.
3. Care should be taken not to over-tighten the screw.

*Installation with impact drivers not recommended.

Recommended for use with:

MAGNETIC NUT SETTER S2 ALLOY STEEL / STANDARD DRIVE BIT 1/4		
Part	QFind	Length (mm)
TXDDPNSS37045	B030	45
TXDDPNSS37065	B055	65



Recommended
HEX 3/8 Magnetic
Nut Setter

SPRING NUT SETTER S2 ALLOY STEEL BLACK / impaX DRIVE BIT 1/4		
Part	QFind	Length (mm)
TXDIPSS37065	BA50	50
TXDIPSS37150	BA51	75



Recommended
HEX 3/8 Spring
Nut Setter

MAGNETIC NUT SETTER S2 ALLOY STEEL BLACK / impaX DRIVE BIT 1/4		
Part	QFind	Length (mm)
TXDIPNSS37045	BA22	45
TXDIPNSS37065	B095	65
TXDIPNSS37150	BA23	150



Recommended
HEX 3/8 Magnetic
Nut Setter

Disclaimer: while every reasonable effort has been made to ensure that this document is correct at the time of printing, Hobson Engineering®, its agencies and employees disclaim all liability in respect to anything or the consequences of anything done or omitted regarding the whole or any part of this document. HEC product marking is the manufacturing mark of Hobson Engineering. HEC is a registered trademark of Hobson Engineering.

Bolt Tension | Anti-Vibration | Product Reliability | Traceability

hobson.com.au **QUALITY FASTENERS SINCE 1935**