



PRODUCT DATA

BDX Metal SDS Wafer Head

Applications	
•	Metal to metal fixing
•	Wall cladding
•	Sheds
•	Fencing and gates
•	Conduit and pipe saddles



Material	 C1022 Hardened
-----------------	--

10 Gauge Wafer Head

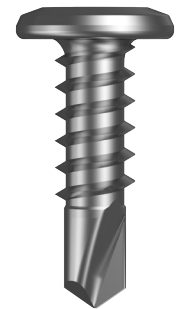

Finish	 X9 Coating
---------------	--

X9 ProteXion coating is suitable for ISO 9223 Category 4 environments.

Dimensions

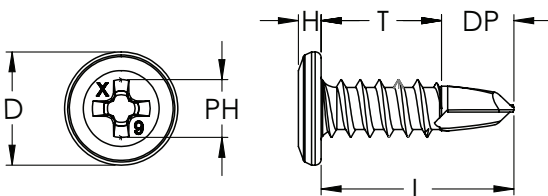

Refer to our documents online for a complete list of available Colorbond® colours.

hobson.com.au

Part	QFind	Gauge	TPI	Length	Thread Length	Drill Point Length	Head Height	Head ø	Drive Size
				L (mm)	T (mm)	DP (mm)	H (mm)	D (mm)	PH (size)
T9PM9WP1016016	QH380	10	16	16	9.8	6.2	2	9	PH #2
T9PM9WP1016022	QH382	10	16	22	15.8	6.2	2	9	PH #2
T9PM9WP1016030	QH384	10	16	30	23.8	6.2	2	9	PH #2
T9PM9WP1016040	QH386	10	16	40	33.8	6.2	2	9	PH #2
T9PM9WP1016050	QH387	10	16	50	43.8	6.2	2	9	PH #2

Disclaimer: while every reasonable effort has been made to ensure that this document is correct at the time of printing, Hobson Engineering®, its agencies and employees disclaim all liability in respect to anything or the consequences of anything done or omitted regarding the whole or any part of this document. HEC product marking is the manufacturing mark of Hobson Engineering. HEC is a registered trademark of Hobson Engineering.

Bolt Tension | Anti-Vibration | Product Reliability | Traceability

hobson.com.au **QUALITY FASTENERS SINCE 1935**



PRODUCT DATA

BDX Metal SDS Wafer Head

Pullout Values

Plate (Purlin)	Metal Plate Thickness	¹ Mean Load	² Characteristic Load	³ Working Load
	(mm)	(N)	(N)	(N)
G2	0.8	1150	1000	400
G2	1.2	2100	1750	700
G550	1.6	4750	4300	1700
G450	2.0	6300	6000	2400
G450	2.5	8000	7350	2950
G2	3.0	8150	7450	3000

Mechanical Properties

Torsional Strength	¹ Mean Tensile Strength	¹ Mean Shear Strength	² Characteristic Tensile Strength	² Characteristic Shear Strength	² Characteristic Shear Strength
(Nm)	(N)	(N)	(N)	(N)	(N)
14.1	21200	12700	20850	12500	7800

Drill Point Test

Plate (Purlin)	Metal Plate Thickness	Load	Drill Speed	Drill Time	Drill Time
	(mm)	(kg)	(RPM)	(Max. individual) Seconds	(Max. average) Seconds
G450	2.5	24	2200	3	2.5

Note: 1000N = 1kN

¹ Mean Load/Strength is the average ultimate strength of samples tested.

² Characteristic Load/Strength: 95% of these screws are expected to have a strength greater than the loads shown.

³ Working Load is the governing minimum allowable load obtained by comparing relevant concrete and steel working loads. Factor of Safety (FOS=2.5 for steel, FOS=2.5 for timber and FOS=3.0 for concrete) are already included.

All values are obtained under laboratory conditions. Safety factors should be considered for design purposes. Actual pullout loads may differ slightly depending on certain properties of the base material.

Disclaimer: while every reasonable effort has been made to ensure that this document is correct at the time of printing, Hobson Engineering®, its agencies and employees disclaim all liability in respect to anything or the consequences of anything done or omitted regarding the whole or any part of this document. HEC product marking is the manufacturing mark of Hobson Engineering. HEC is a registered trademark of Hobson Engineering.

Bolt Tension | Anti-Vibration | Product Reliability | Traceability

hobson.com.au **QUALITY FASTENERS SINCE 1935**

PRODUCT DATA

BDX Metal SDS Wafer Head

Installation

1. Use a cordless screw gun set between 2,200-3,000 RPM. Fit the Phillips Drive Bit over the screw and place at the fastening position.
2. Apply consistently firm pressure to the screw driver while the screw is drilling.
3. Care should be taken not to over-tighten the screw.

*Installation with impact drivers not recommended.

Recommended for use with:

DOUBLE ENDED PHILLIPS S2 ALLOY STEEL / STANDARD DRIVE BIT 1/4		
Part	QFind	Length (mm)
TXDDDPHS20045	B921	45
TXDDDPHS20065	B922	65



Recommended
PH #2 Double Ended
Phillips

POWER PHILLIPS S2 ALLOY STEEL / STANDARD DRIVE BIT 1/4		
Part	QFind	Length (mm)
TXDDPPHS20050	B315	50
TXDDPPHS20075	B317	75
TXDDPPHS20100	B325	100
TXDDPPHS20150	B330	150



Recommended
PH #2 Power
Phillips

INSERT PHILLIPS S2 ALLOY TITAN / TITANIUM NITRIDE DRIVE BIT 1/4		
Part	QFind	Length (mm)
TXDTIPHS20025	B235	25

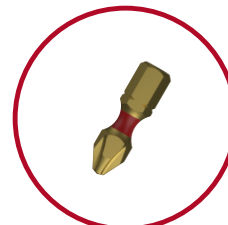

Recommended
PH #2 Insert
Phillips

Disclaimer: while every reasonable effort has been made to ensure that this document is correct at the time of printing, Hobson Engineering®, its agencies and employees disclaim all liability in respect to anything or the consequences of anything done or omitted regarding the whole or any part of this document. HEC product marking is the manufacturing mark of Hobson Engineering. HEC is a registered trademark of Hobson Engineering.