



# Product Data Sheet

## Type 17 Washer Head TORX Drive T40 Self Drilling Timber Construction Screw

TYKOTE® / AS3566 INTERNAL HEX DRIVE / C1022 HARDENED

**Finish:** TYKOTE® is a high performance coating, specially formulated for resisting treated pine chemicals.

**Application:** Connecting heavy duty treated timber to timber.

**DRILLX**  
**TYKOTE**

Part	QFind	Gauge	TPI	Length	Thread Length	Pack Qty
			(mm)	(mm)	(mm)	
T9PWTGO1805075	QA64	18	5	75	38	250
T9PWTGO1805100	QA65	18	5	100	60	250
T9PWTGO1805125	QA66	18	5	125	70	200
T9PWTGO1805150	QA67	18	5	150	70	100
T9PWTGO1805200	QA68	18	5	200	70	100
T9PWTGO1805250	QA69	18	5	250	70	100

Mechanical Properties	Characteristic*
Tensile Strength (N)	23.6
Shear Strength (N)	12.9

### Ultimate Pullout Strength in H2 Treated F5 Radiata Pine (Screw is transverse to grain)

Thread Length Embedded	Mean^	Characteristic*
(mm)		
29	6,170	4,860
56	17,810	17,630

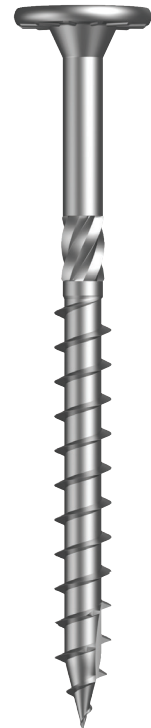

Torx 40  
Drive

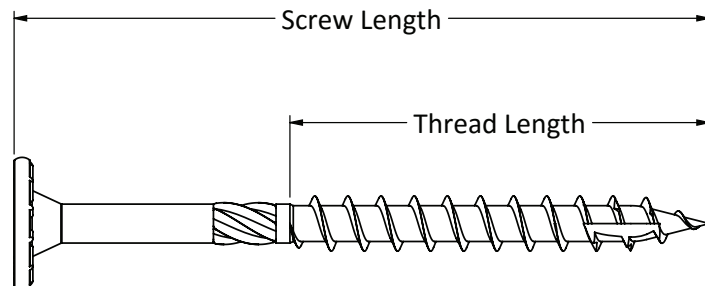
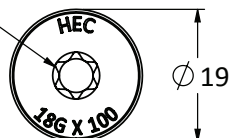

All values are obtained under laboratory conditions using DRILLX® product. Safety factors should be considered for design purposes.

\* Characteristic Strength – is the 5% fractile strength which has a 95% probability of being exceeded at a confidence level of 90%.

^ Mean Ultimate Strength – is the average ultimate strength of samples tested.



1704113HS

HOBSONSPECS



# Product Data Sheet

Type 17 Washer Head TORX Drive T40  
Self Drilling Timber Construction Screw

## Type 17 Washer Head

### Applications:

Ideal for outdoor construction of pergolas, retaining walls, fencing and gates.

# TORX

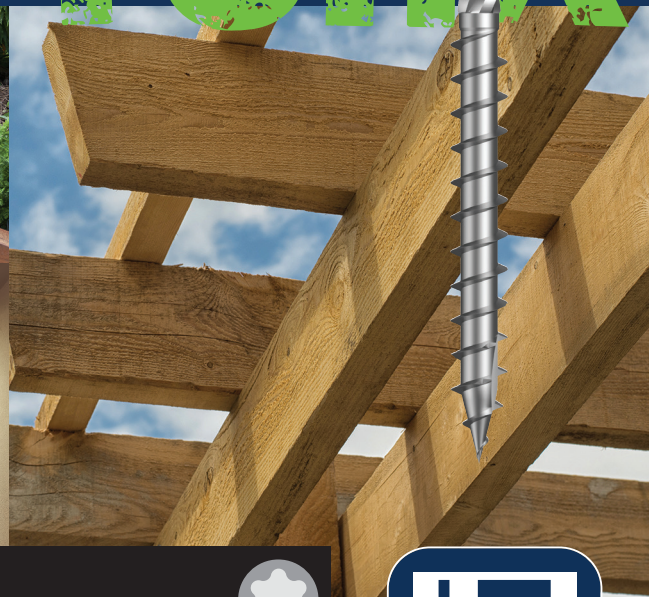

### TYPE 17 WASHER HEAD INTERNAL TORX DRIVE – T40



Part	QFind	Size	Length (mm)	Pack	Finish
T9PWTGO1805075	QA64	#18-5	75	250	TYKOTE®
T9PWTGO1805100	QA65	#18-5	100	250	TYKOTE®
T9PWTGO1805125	QA66	#18-5	125	200	TYKOTE®
T9PWTGO1805150	QA67	#18-5	150	100	TYKOTE®
T9PWTGO1805200	QA68	#18-5	200	100	TYKOTE®
T9PWTGO1805250	QA69	#18-5	250	100	TYKOTE®

# TYKOTE®

A high performance coating, specially formulated for resisting treated pine chemicals.