



# PRODUCT DATA



## Metal SDS Flanged Hex Head

Page 1 of 2

### Metal to metal fixing

Applications
<ul style="list-style-type: none"> <li>• Wall cladding</li> <li>• Sheds</li> <li>• Fencing and gates</li> <li>• Signs</li> <li>• Hinges into metal posts/gates/doors</li> </ul>

# DRILLX®

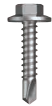
<b>Material</b>	 1022 SAE1022	
<b>Finish</b>	 CL4 Class 4	

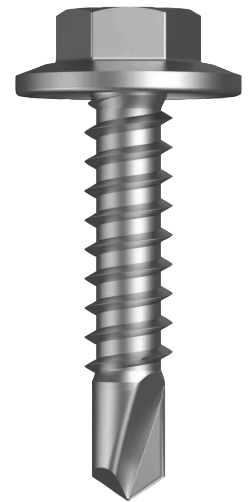

### Pullout Values

Plate Material	Metal Plate Thickness	<sup>1</sup> Characteristic Strength	<sup>2</sup> Working Load
	(mm)	(N)	(N)
G2 Purlin	1.1	1410	560
G450 Purlin	1.9	4640	1850
G450 Purlin	2.4	6210	2480
G450 Purlin	3.8	9610	3840

<sup>1</sup> Characteristic Strength - is the 5% fractile strength which has a 95% probability of being exceeded at a confidence level of 90% (95% of these screws are expected to have a strength greater than this characteristic strength).

<sup>2</sup> Working Load is the governing minimum allowable load obtained by comparing relevant concrete and steel working loads. Factor of Safety (FOS=2.5 for steel and FOS=3.0 for concrete) are already included.

All values are obtained under laboratory conditions using DRILLX® product. Safety factors should be considered for design purposes.

Part	Drill Point Test					Mechanical Properties		
	Plate Type	Load	Drill Speed	Drill Time	Drill Time	Torsional Strength	Characteristic Shear Strength	Characteristic Tensile Strength
	(mm)	(kg)	(RPM)	(Max. individual) Seconds	(Max. average) Seconds	(Nm)	(N)	(N)
T9PM4FH1214020	1.9 G450	18	2200	4	3.5	10.9	8260	13780
T9PM4FH1214025								
T9PM4FH1214030				5.5	4			
T9PM4FH1214035								
T9PM4FH1214045								

Disclaimer: While every reasonable effort has been made to ensure that this document is correct at the time of printing, Hobson® Engineering, its agencies and employees, disclaim any and all liability to any person in respect of anything or the consequences of anything done or omitted to be done in reliance upon the whole or any part of this document.

Bolt Tension | Anti-Vibration | Product Reliability | Traceability

[hobson.com.au](http://hobson.com.au) **QUALITY FASTENERS SINCE 1935**



# PRODUCT DATA

## Metal SDS Flanged Hex Head

Page 2 of 2

Part	QFind	Gauge	TPI	Length		Drill Point Length	Head Height	Head $\varnothing$	Drive Size	Pack Qty
				L (mm)	T (mm)					
T9PM4FH1214020	Q190	12	14	20	13	7.4	5.5	14.4	HEX 5/16"	1000
T9PM4FH1214025	Q509			25	18					
T9PM4FH1214030	Q193			30	23					
T9PM4FH1214035	Q195			35	28					
T9PM4FH1214045	Q200			45	38					

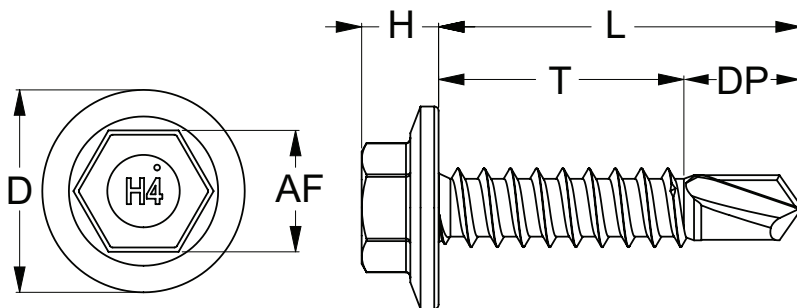

### Installation

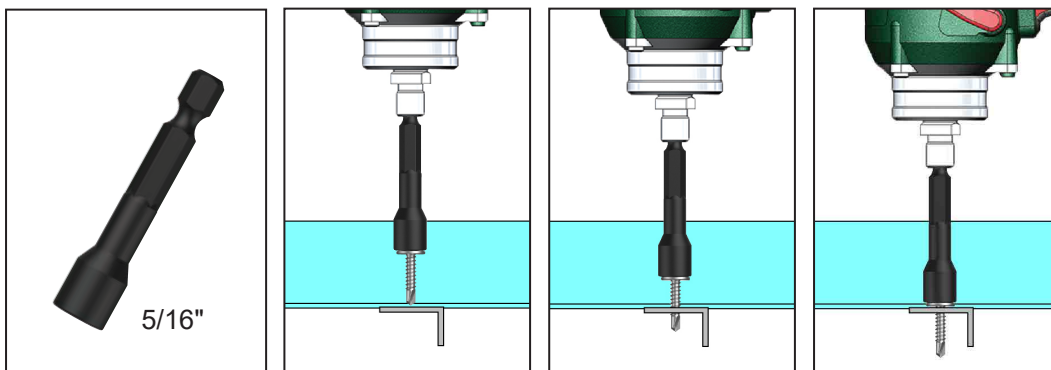

#### Recommended

Hobson® HEX 5/16 inch Drive Bit:

TXDIPNSS31045 - 45mm  
 TXDIPNSS31065 - 65mm  
 TXDIPNSS31100 - 100mm  
 TXDIPNSS31150 - 150mm  
 TXDIPNSS31200 - 200mm  
 TXDIPNSS31300 - 300mm

#### Installation Guide

1. Use a cordless screw driver set between 2,200-3,000 RPM. Fit the HEX Drive Bit over the screw and place at the fastening position.
2. Apply consistently firm pressure to the screw driver while the screw is drilling.
3. Care should be taken not to overtighten the screw.

\*Installation with impact drivers not recommended.

Disclaimer: While every reasonable effort has been made to ensure that this document is correct at the time of printing, Hobson® Engineering, its agencies and employees, disclaim any and all liability to any person in respect of anything or the consequences of anything done or omitted to be done in reliance upon the whole or any part of this document.

Bolt Tension | Anti-Vibration | Product Reliability | Traceability

[hobson.com.au](http://hobson.com.au) **QUALITY FASTENERS SINCE 1935**