



PRODUCT DATA

Metal SDS Flanged Hex Head

Page 1 of 2

Metal to metal fixing

Applications
<ul style="list-style-type: none"> • Wall Cladding • Sheds • Fencing and Gates • Signs • Hinges into Metal Posts/Gates/Doors

DRILLX®



Material	1022 SAE1022	
Finish	CL4 Class 4	

Pullout Values

Plate Material	Metal Plate Thickness	¹ Mean Load	² Characteristic Load	³ Working Load
	(mm)	(N)	(N)	(N)
G2 Purlin	0.7	950	900	350
G2 Purlin	1.1	1800	1600	650
G550 Purlin	1.5	4000	3600	1400
G450 Purlin	1.9	5200	4900	1950
G450 Purlin	2.4	7150	6300	2500

Part	Drill Point Test					Mechanical Properties				
	Plate Type	Load	Drill Speed	Drill Time	Drill Time	Torsional Strength	¹ Mean Tensile Strength	¹ Mean Shear Strength	² Characteristic Tensile Strength	² Characteristic Shear Strength
	(mm)	(kg)	(RPM)	(Max. individual Seconds)	(Max. average) Seconds	(Nm)	(N)	(N)	(N)	(N)
T9PM4FH1016016	1.9 G450	18	2200	4	3	6.9	12700	7600	11550	6950
T9PM4FH1016025										

Note: 1000N = 1kN

¹ Mean Load/Strength is the average ultimate strength of samples tested.

² Characteristic Load/Strength: 95% of these screws are expected to have a strength greater than the loads shown.

³ Working Load is the governing minimum allowable load obtained by comparing relevant concrete and steel working loads. Factor of Safety (FOS=2.5 for steel and FOS=3.0 for concrete) are already included.

All values are obtained under laboratory conditions using DRILLX® product. Safety factors should be considered for design purposes. Actual pull out loads may differ depending on certain properties of the base material.

Disclaimer: While every reasonable effort has been made to ensure that this document is correct at the time of printing, Hobson Engineering®, its agencies and employees, disclaim any and all liability to any person in respect of anything or the consequences of anything done or omitted to be done in reliance upon the whole or any part of this document.

Bolt Tension | Anti-Vibration | Product Reliability | Traceability

hobson.com.au **QUALITY FASTENERS SINCE 1935**



200612DS



PRODUCT DATA

Metal SDS Flanged Hex Head

Page 2 of 2

Part	QFind	Gauge	TPI	Length	Thread Length	Drill Point Length	Head Height	Head ø	Drive Size	Pack Qty
				L (mm)	T (mm)	DP (mm)	H (mm)	D (mm)	AF (inch)	
T9PM4FH1016016	Q180	10	16	16	9.8	6.2	4.5	11.0	HEX 5/16"	1000
T9PM4FH1016025	Q185			25	18.8					

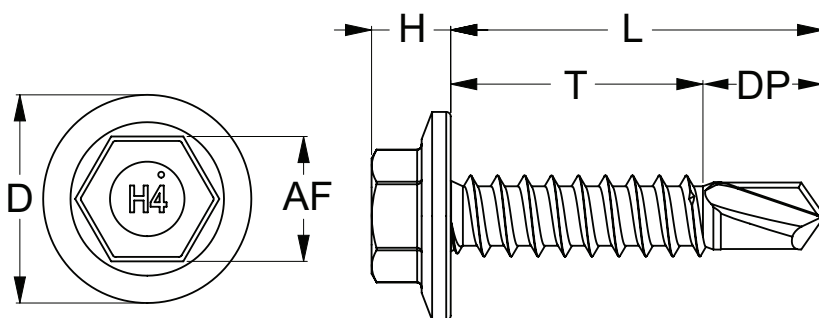

Installation

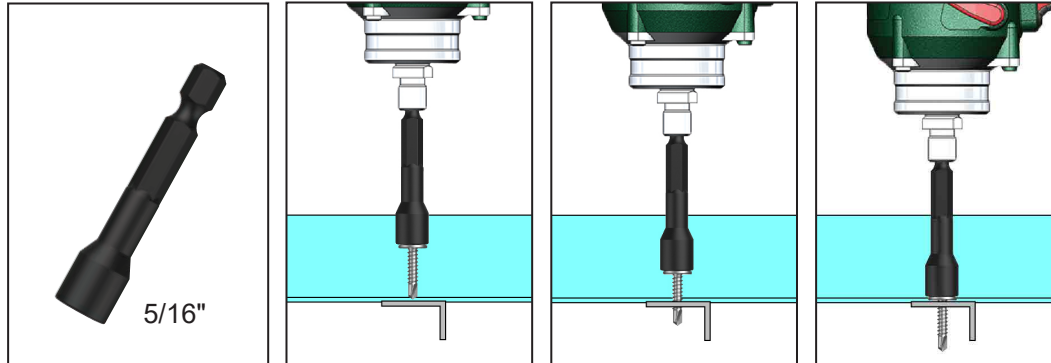

Recommended
HEX 5/16 inch Drive Bit:

TXDIPNSS31045 - 45mm
TXDIPNSS31065 - 65mm
TXDIPNSS31100 - 100mm
TXDIPNSS31150 - 150mm
TXDIPNSS31200 - 200mm
TXDIPNSS31300 - 300mm

Installation Guide

1. Use a cordless screw driver set between 2,200-3,000 RPM. Fit the HEX Drive Bit over the screw and place at the fastening position.
2. Apply consistently firm pressure to the screw driver while the screw is drilling.
3. Care should be taken not to overtighten the screw.

*Installation with impact drivers not recommended.

Disclaimer: While every reasonable effort has been made to ensure that this document is correct at the time of printing, Hobson Engineering®, its agencies and employees, disclaim any and all liability to any person in respect of anything or the consequences of anything done or omitted to be done in reliance upon the whole or any part of this document.

Bolt Tension | Anti-Vibration | Product Reliability | Traceability

hobson.com.au **QUALITY FASTENERS SINCE 1935**