

PRODUCT DATA

Metal SDS Flanged Hex Head

Applications	
•	Metal to Metal fixing
•	Hinge into metal posts, gates and doors
•	Wall cladding
•	Sheds
•	Fencing and gates
•	Stitching for roof flashing



Material	C1022 Hardened
-----------------	----------------

12 Gauge Hex Head

Finish	X9 Coating
---------------	------------

X9 ProteXion coating is suitable for ISO 9223 Category 4 environments.

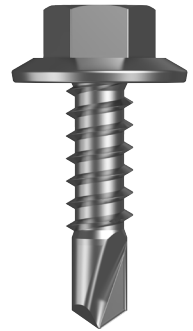

Dimensions

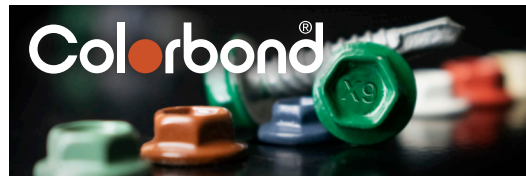
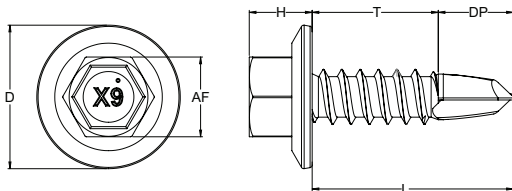

Refer to our documents online for a complete list of available Colorbond® colours.

hobson.com.au

Part	QFind	Gauge	TPI	Length	Thread Length	Drill Point Length	Head Height	Head ø	Drive Size
				L (mm)	T (mm)	DP (mm)	H (mm)	D (mm)	AF (inch)
T9PM9FH1214020	QH190	12	14	20	12.5	7.5	6.5	14	HEX 5/16
T9PM9FH1214025	QH509	12	14	25	17.5	7.5	6.5	14	HEX 5/16
T9PM9FH1214030	QH193	12	14	30	22.5	7.5	6.5	14	HEX 5/16
T9PM9FH1214035	QH195	12	14	35	27.5	7.5	6.5	14	HEX 5/16
T9PM9FH1214045	QH200	12	14	45	37.5	7.5	6.5	14	HEX 5/16

Disclaimer: while every reasonable effort has been made to ensure that this document is correct at the time of printing, Hobson Engineering®, its agencies and employees disclaim all liability in respect to anything or the consequences of anything done or omitted regarding the whole or any part of this document. HEC product marking is the manufacturing mark of Hobson Engineering. HEC is a registered trademark of Hobson Engineering.

Bolt Tension | Anti-Vibration | Product Reliability | Traceability

hobson.com.au **QUALITY FASTENERS SINCE 1935**



PRODUCT DATA

Metal SDS Flanged Hex Head

Pullout Values

Plate (Purlin)	Metal Plate Thickness	² Characteristic Load	³ Working Load
	(mm)	(N)	(N)
G2	1.1	1410	560
G450	1.9	4640	1850
G450	2.4	6210	2480
G450	3.8	9610	3840

Mechanical Properties

Torsional Strength	¹ Mean Tensile Strength	¹ Mean Shear Strength	² Characteristic Tensile Strength	² Characteristic Shear Strength
(Nm)	(N)	(N)	(N)	(N)
10.9	13780	8260	13780	8260

Drill Point Test

Plate (Purlin)	Metal Plate Thickness	Load	Drill Speed	Drill Time	Drill Time
	(mm)	(kg)	(RPM)	(Max. individual) Seconds	(Max. average) Seconds
G450	1.9	18	2200	3.5	3

Note: 1000N = 1kN

¹ Mean Load/Strength is the average ultimate strength of samples tested.

² Characteristic Load/Strength: 95% of these screws are expected to have a strength greater than the loads shown.

³ Working Load is the governing minimum allowable load obtained by comparing relevant concrete and steel working loads. Factor of Safety (FOS=2.5 for steel, FOS=2.5 for timber and FOS=3.0 for concrete) are already included.

All values are obtained under laboratory conditions. Safety factors should be considered for design purposes. Actual pullout loads may differ slightly depending on certain properties of the base material.

Disclaimer: while every reasonable effort has been made to ensure that this document is correct at the time of printing, Hobson Engineering®, its agencies and employees disclaim all liability in respect to anything or the consequences of anything done or omitted regarding the whole or any part of this document. HEC product marking is the manufacturing mark of Hobson Engineering. HEC is a registered trademark of Hobson Engineering.

Bolt Tension | Anti-Vibration | Product Reliability | Traceability

hobson.com.au **QUALITY FASTENERS SINCE 1935**

PRODUCT DATA

Metal SDS Flanged Hex Head

Installation

1. Use a cordless screw gun set between 2,200–3,000 RPM. Fit the HEX Drive Bit over the screw and place at the fastening position.
2. Apply consistently firm pressure to the screw driver while the screw is drilling.
3. Care should be taken not to over-tighten the screw.

*Installation with impact drivers not recommended.

Recommended for use with:

MAGNETIC NUT SETTER S2 ALLOY STEEL BLACK / impaX DRIVE BIT 1/4		
Part	QFind	Length (mm)
TXDIPNSS31045	BA18	45
TXDIPNSS31065	B090	65



Recommended
HEX 5/16 Magnetic
Nut Setter

MAGNETIC NUT SETTER S2 ALLOY STEEL BLACK / STANDARD DRIVE BIT 1/4		
Part	QFind	Length (mm)
TXDDPNSS31045	B025	45
TXDDPNSS31065	B050	65
TXDDPNSS31100	B060	100
TXDDPNSS31150	B075	150



Recommended
HEX 5/16 Magnetic
Nut Setter

SPRING NUT SETTER S2 ALLOY STEEL BLACK / impaX DRIVE BIT 1/4		
Part	QFind	Length (mm)
TXDIPSS31065	BA48	65
TXDIPSS31150	BA49	150



Recommended
HEX 5/16 Spring
Nut Setter

Disclaimer: while every reasonable effort has been made to ensure that this document is correct at the time of printing, Hobson Engineering®, its agencies and employees disclaim all liability in respect to anything or the consequences of anything done or omitted regarding the whole or any part of this document. HEC product marking is the manufacturing mark of Hobson Engineering. HEC is a registered trademark of Hobson Engineering.

Bolt Tension | Anti-Vibration | Product Reliability | Traceability

hobson.com.au **QUALITY FASTENERS SINCE 1935**