



PRODUCT DATA

Type 17 Flanged Hex Head, Scratchguard® & Seal

Self Drilling Timber Screw (SDS) #14-10

Applications	
<ul style="list-style-type: none"> For fixing steel roofing and cladding to timber framing 	

Material	 1022 C1022 Hardened
-----------------	-------------------------------------------------------------------------------------------------------

Finish	 CL4 Class 4
---------------	------------------------------------------------------------------------------------------------

Pullout Values				
Plate Material	Timber Embedment	¹ Mean Load	² Characteristic Load	³ Working Load
	(mm)	(N)	(N)	(N)
F7 Pine	35	6450	4350	1750
F27 Hardwood	35	9800	7850	3150

Mechanical Properties				
Torsional Strength	¹ Mean Tensile Strength	¹ Mean Shear Strength	² Characteristic Tensile Strength	² Characteristic Shear Strength
(Nm)	(N)	(N)	(N)	(N)
14.1	20100	12050	17100	10250

14 Gauge Flanged Hex Head

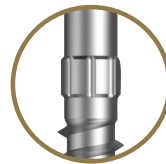
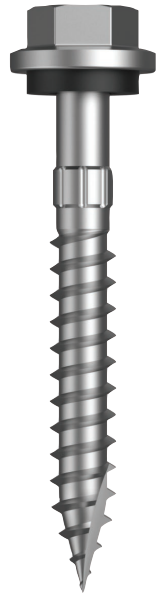

Note: 1000N = 1kN

¹ Mean Load/Strength is the average ultimate strength of samples tested.

² Characteristic Load/Strength: 95% of these screws are expected to have a strength greater than the loads shown.

³ Working Load is the governing minimum allowable load obtained by comparing relevant concrete and steel working loads. Factor of Safety (FOS=2.5 for steel, FOS=2.5 for timber and FOS=3.0 for concrete) are already included.

All values are obtained under laboratory conditions using DRILLX product. Safety factors should be considered for design purposes. Actual pullout loads may differ slightly depending on certain properties of the base material.

Disclaimer: While every reasonable effort has been made to ensure that this document is correct at the time of printing, Hobson Engineering®, its agencies and employees, disclaim any and all liability to any person in respect of anything or the consequences of anything done or omitted to be done in reliance upon the whole or any part of this document.



Bolt Tension | Anti-Vibration | Product Reliability | Traceability

hobson.com.au **QUALITY FASTENERS SINCE 1935**





PRODUCT DATA

Type 17 Flanged Hex Head, Scratchguard® & Seal

Part	QFind	Gauge	TPI	Length	Thread Length	Head Height	Head ø	Drive Size
				L (mm)	T (mm)	H (mm)	D (mm)	AF (inch)
T9PW4SS1410050	Q625	14	10	50	35	6	14.5	HEX 3/8"
T9PW4SS1410065	Q630			65	45			
T9PW4SS1410075	Q635			75	50			
T9PW4SS1410090	Q640			90	60			
T9PW4SS1410100	Q645			100	60			
T9PW4SS1410115	Q650			115	60			
T9PW4SS1410125	Q655			125	60			
T9PW4SS1410150	Q660			150	100			

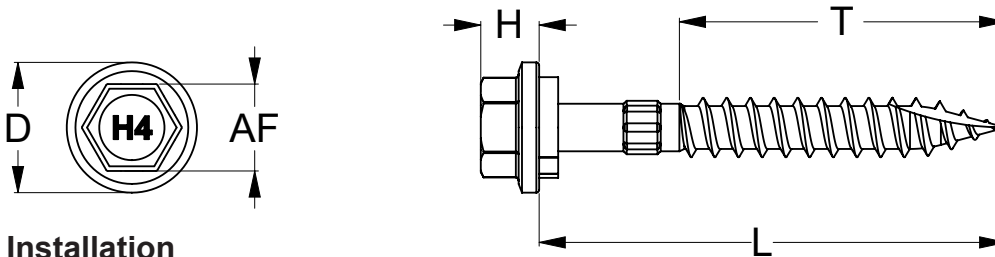

Installation

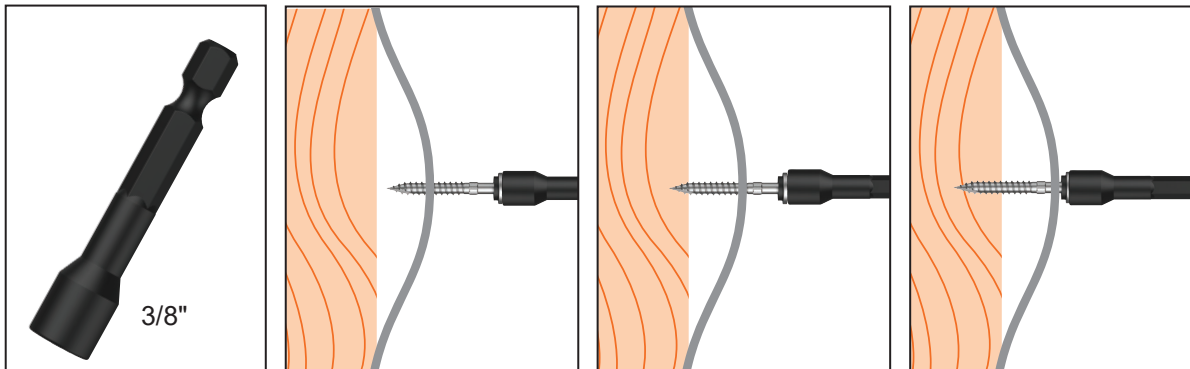

Recommended HEX 3/8" Drive Bits:

Part	QFind	Length
		(mm)
TXDIPNSS37045	BA22	45
TXDIPNSS37065	B095	65
TXDIPNSS37150	BA23	150

Installation Guide

1. Use a cordless screw driver set at max 1,500 RPM. Fit the Hex Drive Bits over the screw and place at the fastening position.
2. Apply consistently firm pressure to the screw driver while the screw is drilling.
3. Care should be taken not to over-tighten the screw.

*Installation with impact drivers not recommended.

Disclaimer: While every reasonable effort has been made to ensure that this document is correct at the time of printing, Hobson Engineering®, its agencies and employees, disclaim any and all liability to any person in respect of anything or the consequences of anything done or omitted to be done in reliance upon the whole or any part of this document.

Bolt Tension | Anti-Vibration | Product Reliability | Traceability