



# PRODUCT DATA

## Grade 80 Master Link Assembly

Master link assembly allows up to four leg sling lifts with a variety of sling materials.

### Applications

- Use with Grade 80 lifting components
- Lifting with G80 2-4 leg chain slings, wire rope and synthetic slings

### Material



### Finish



### Features

- Conforms to AS 3776
- 100% magnaflux crack detection
- Working load limit for three or four leg lifting between 0-45 degrees

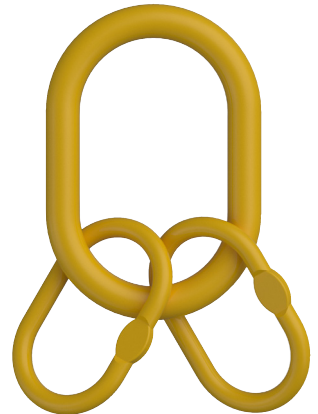

Part	QFind	Chain Size	WLL	BL	Dimensions					
		3 or 4 leg lift (mm)	(tonne)	(tonne)	A (mm)	B (mm)	D (mm)	a (mm)	b (mm)	d (mm)
ULCL08PMA-07	<b>CMA7</b>	7	5.5	22.0	160	95	20	110	60	13
ULCL08PMA-08	<b>CMA8</b>	8	6.65	26.6	160	95	22	140	80	16
ULCL08PMA-10	<b>CMA10</b>	10	9.40	37.6	190	110	26	160	95	20
ULCL08PMA-13	<b>CMA13</b>	13	14.20	56.8	230	130	32	190	110	26
ULCL08PMA-16	<b>CMA16</b>	16	22.30	89.2	275	150	38	230	130	30
ULCL08PMA-20	<b>CMA20</b>	20	33.50	134.0	340	180	45	230	130	32
ULCL08PMA-22	<b>CMA22</b>	22	40.80	163.2	350	190	50	275	150	38
ULCL08PMA-26	<b>CMA26</b>	26	56.80	227.2	400	200	56	340	180	45

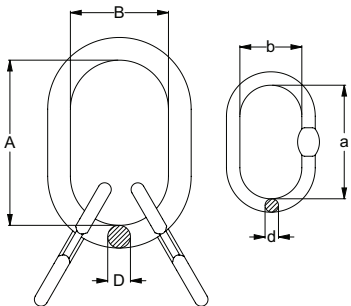

### MARKINGS:

- **CE** (European Conformity)
- **WLL** (Working Load Limit)
- **Trace Code** (linked to certificate online)
- **Manufacturer's mark**



You can download this  
Test Certificate and/or  
Report from our website:

**[hobson.com.au](http://hobson.com.au)**

Disclaimer: while every reasonable effort has been made to ensure that this document is correct at the time of printing, Hobson Engineering®, its agencies and employees disclaim all liability in respect to anything or the consequences of anything done or omitted regarding the whole or any part of this document.

Bolt Tension | Anti-Vibration | Product Reliability | Traceability

**[hobson.com.au](http://hobson.com.au) QUALITY FASTENERS SINCE 1935**